

CB300

HVAC Gateway

HVAC (Air Conditioner) communication gateway connects to indoor-outdoor transmission line of the air conditioning system and translate native (proprietary) air conditioner language to KNX, Modbus and Serial Terminal interface allowing supervision and bidirectional control of most parameters of VRV/VRF and standard air conditioning devices from automation systems.



Product Specification

Product name	CB300
Power supply	24 VDC 0.2 A
Physical interface	1 x AC, 1 x KNX, 1 x RS-485, 1 x RS-232, 1 x LGAP, 1 x IR, 1 x USB
Communication Protocols	KNX, Modbus, Serial Terminal, Daikin, Mitsubishi Electric, LG, Beko, Arcelik
Digital Inputs	None
Devices Per Network (Max)	As many as indoor units installed on the bus
Connection with A/C unit	Indoor-outdoor transmission line (2-core shielded cable)
Dimensions (W x H x D)	86 x 70 x 56 mm (4 DIN units)
Weight	0.15 kg
Case material	Plastic DIN Rail mounting
Operating Temperature Range	0 °C...+45 °C
Storage & Transportation Temperature	-10 °C...+70 °C
Maximum Air Humidity	90%
Protection Level	IP20

Product Features

Compliant with major brands (check with your representative for up to date compatibility list)
Targeting Hotel, Home Automation and Office applications
Suitable for applications with numerous indoor units connected to an outdoor unit
ETS library available, supports KNX TP
Supports Modbus on RS-485 port
Serial terminal is compatible with legacy HVAC gateways, no need for developing new drivers
USB port has built-in virtual COM port emulation, no need for USB/RS-232 converters

CB300

HVAC Gateway



Installation

Independent device to be mounted inside distribution boxes or electrical panels.

Connection Diagram

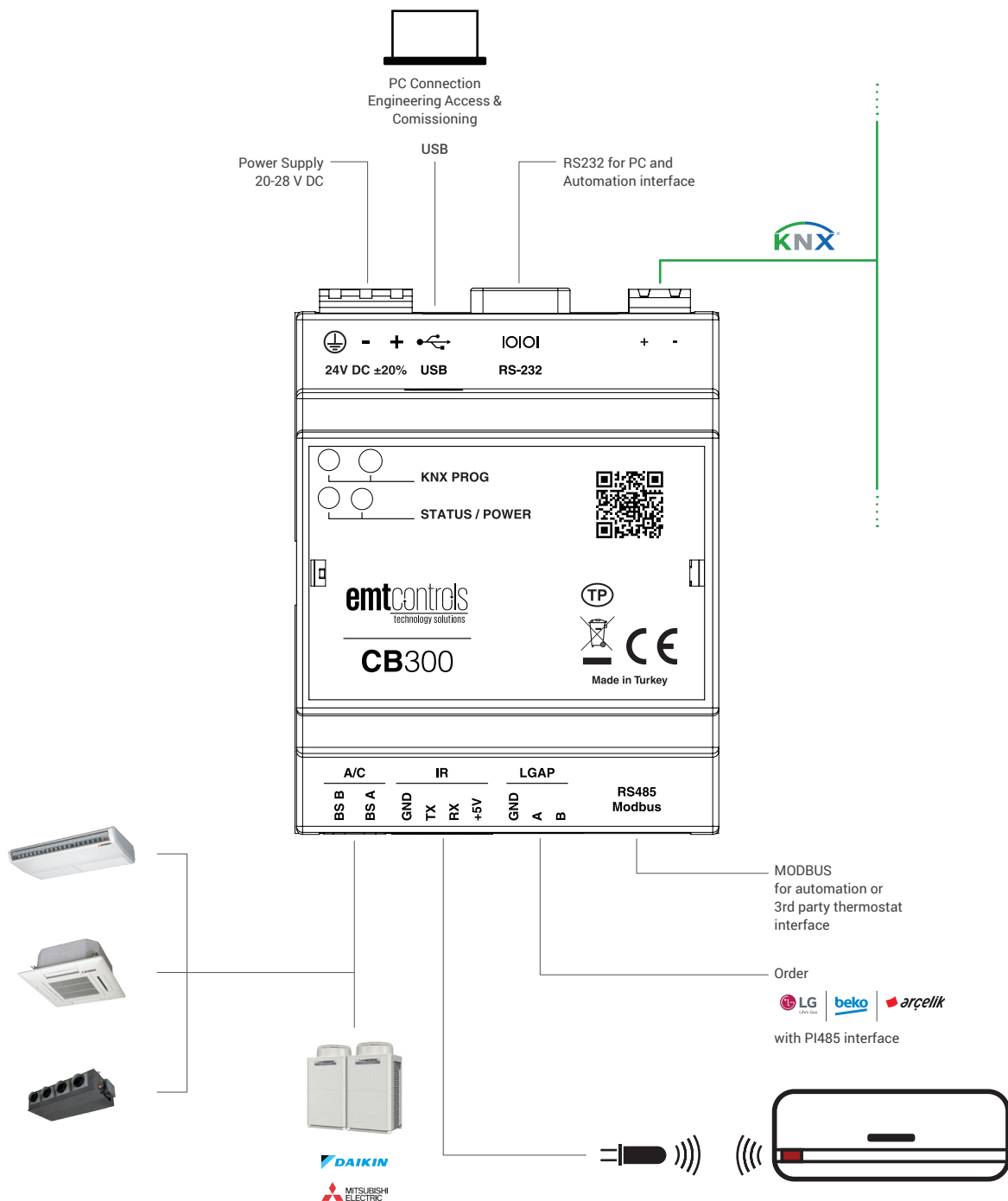

CB300

HVAC Gateway



Indoor-Outdoor Transmission Line Connection

Direct connection to F1/F2 connectors that can be found at the PCB of the outdoor and indoor units

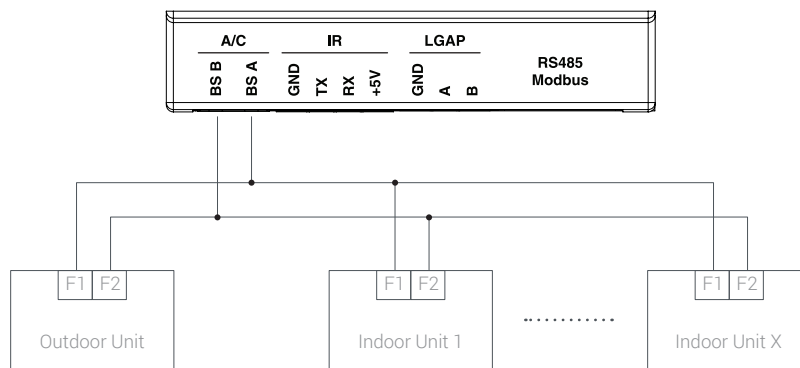

Infrared Connection

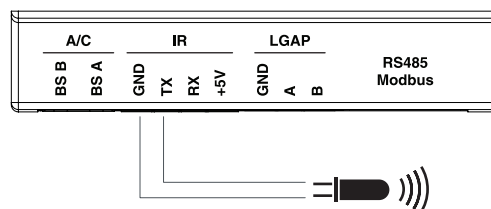

Connection of IR Transceiver (IR LED)

CB300

HVAC Gateway



Dimensions

Top & Side views (mm) (as mounted on the DIN Rail)

