

HTP95-9

Glass Touch Panel with RGB LEDs and up to 9 Buttons

HTP95-9 is a full color glass touch panel with easy to use buttons and RGB backlights.

Supports KNX, RS485 Modbus, Z-wave communication and compatible with UK/EU standard back boxes.

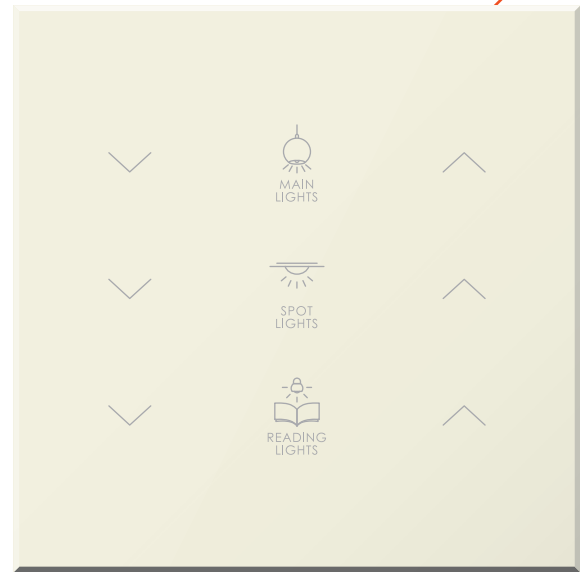

Product Specification

Product Name	HTP95-9
Dimensions (H x W x D)	95 x 95 x 9 mm
Weight	85 g
Frame Options	Glass surface with customizable background color
Supply Voltage	30V for HTP95-9-KNX 24V for HTP95-9
Supply Frequency	DC voltage
Current Consumption	10 mA (eco mode), 25mA (bright mode) for HTP95-9-KNX 80 mA for HTP95-9
Power Supply Options	via bus cable
Physical Interfaces	KNX for HTP95-9-KNX RS485 for HTP95-9
Communication Protocols	KNX for HTP95-9-KNX Modbus for HTP95-9

Temperature Sensor	NTC, 0.5 °C Accuracy
Max Quantity of buttons	9
Status Indicators / Backlight	Individually programmable backlight color and brightness
Mounting	Snap-in magnetic mounting
Warm Up Time	20 seconds
Operating Temperature Range	0 °C...+45 °C
Storage & Transportation Temperature	-10 °C...+70 °C
Maximum Air Humidity	90%
Protection Level	IP20

Dimensions

Top & Side views (mm)

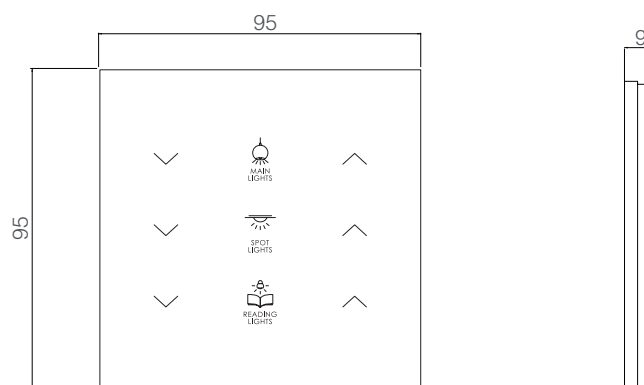

HTP95-9

Glass Touch Panel with RGB LEDs and up to 9 Buttons

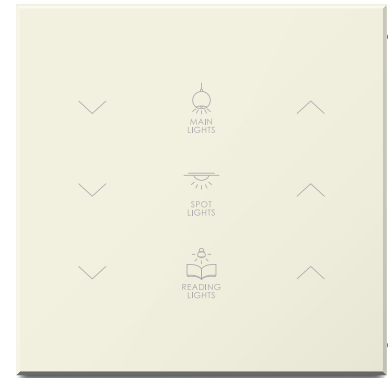

Button Combinations

with a various background colors

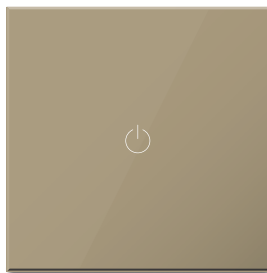

HTP95-1

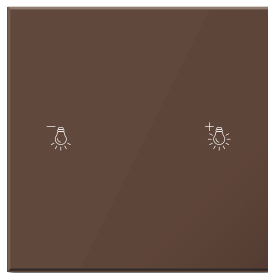

HTP95-2



HTP95-3



HTP95-4

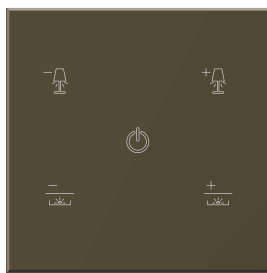

HTP95-5



HTP95-6

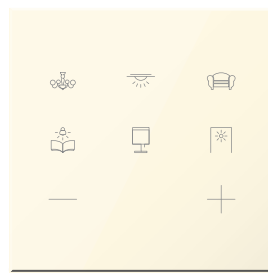

HTP95-7

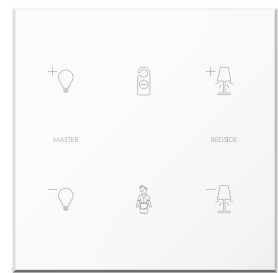

HTP95-8

Back Box Options

EU 2M Standard

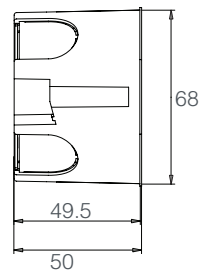
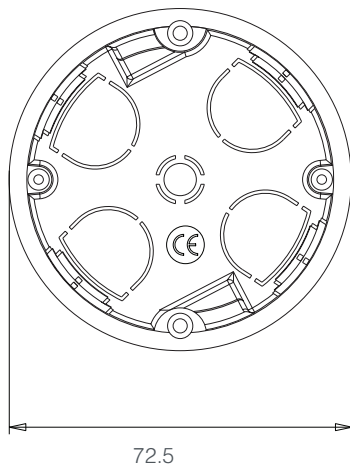

UK 3x3 Standard

